



# Global Exhibition

---

3D Design\_small v1.0

# Contents

1. Type A: 3m x 6m (2 Side Open)
2. Type B: 6m x 6m (2 Side Open)
3. Type C: 6m x 6m (3 Side Open)

# Floor Plan: Type A (3m x 6m, 2 Side open)

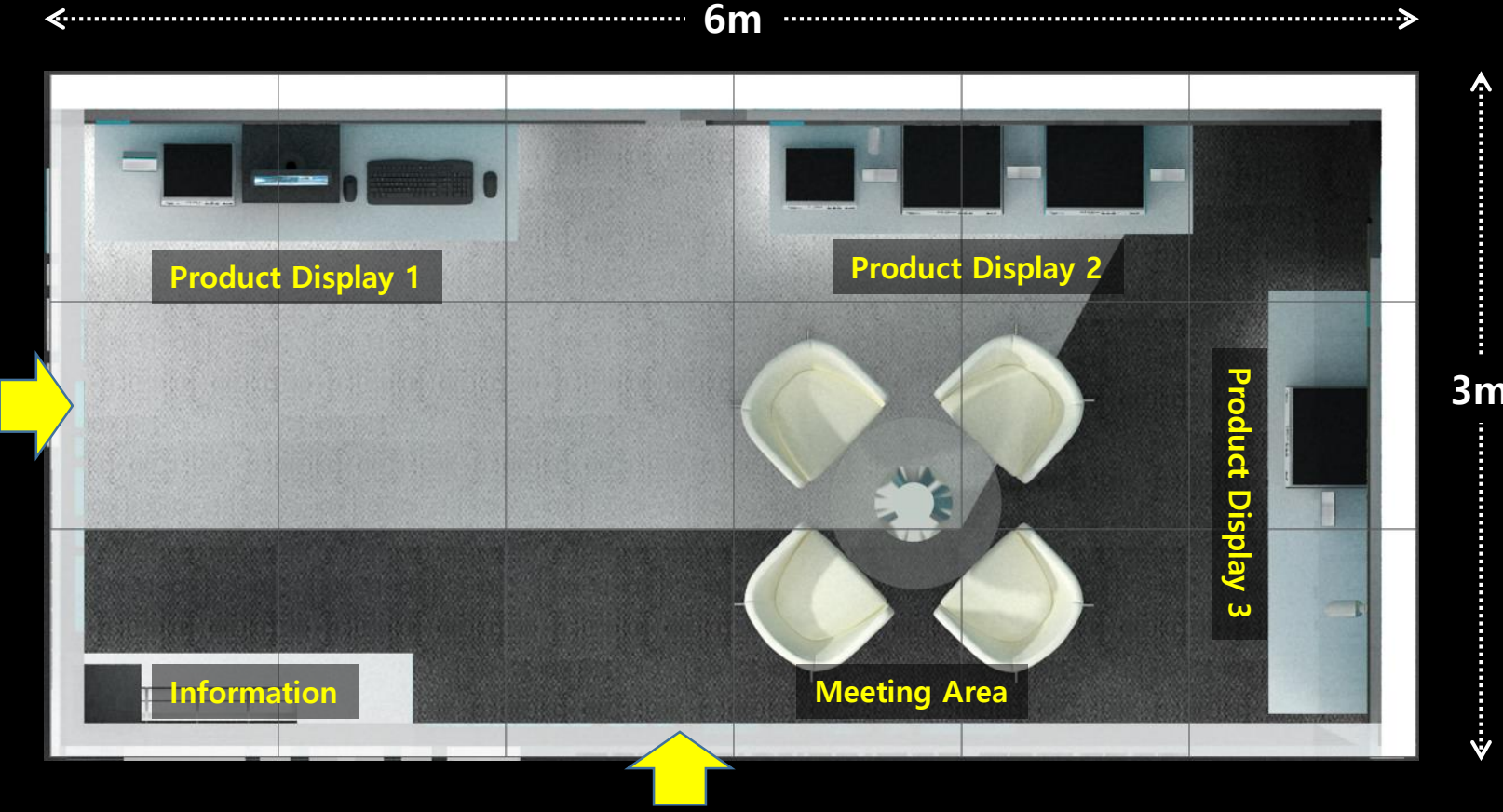

# Iso View: Type A



# Perspective: Type A





# Floor Plan: Type B (6m x 6m, 2 Side open)

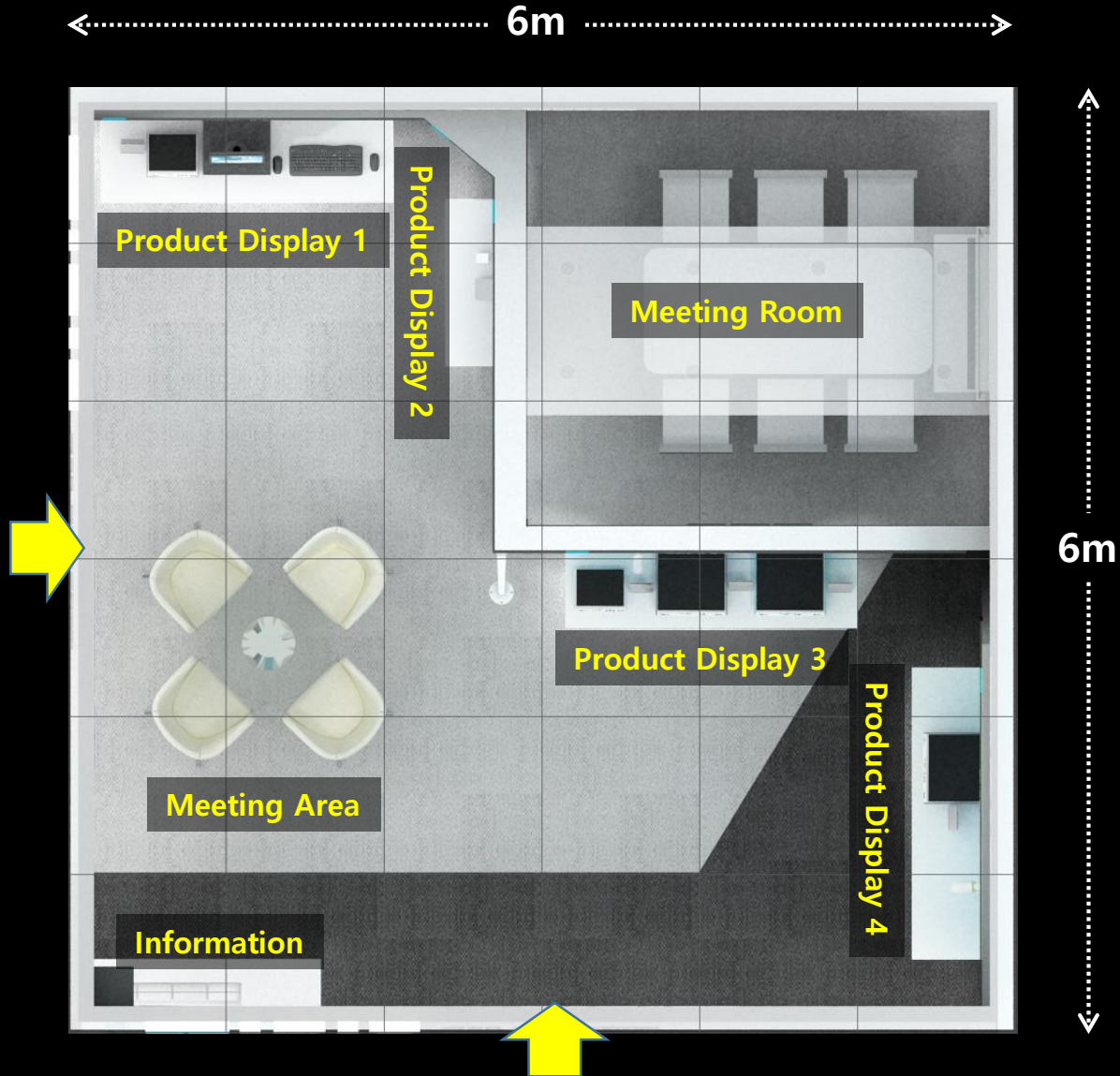

# Iso View: Type B





# Perspective: Type B

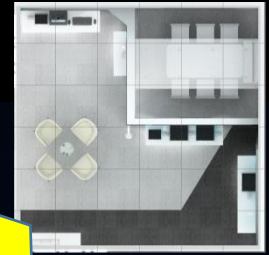

# Perspective: Type B



# Floor Plan: Type C (6m x 6m, 3 Side open)

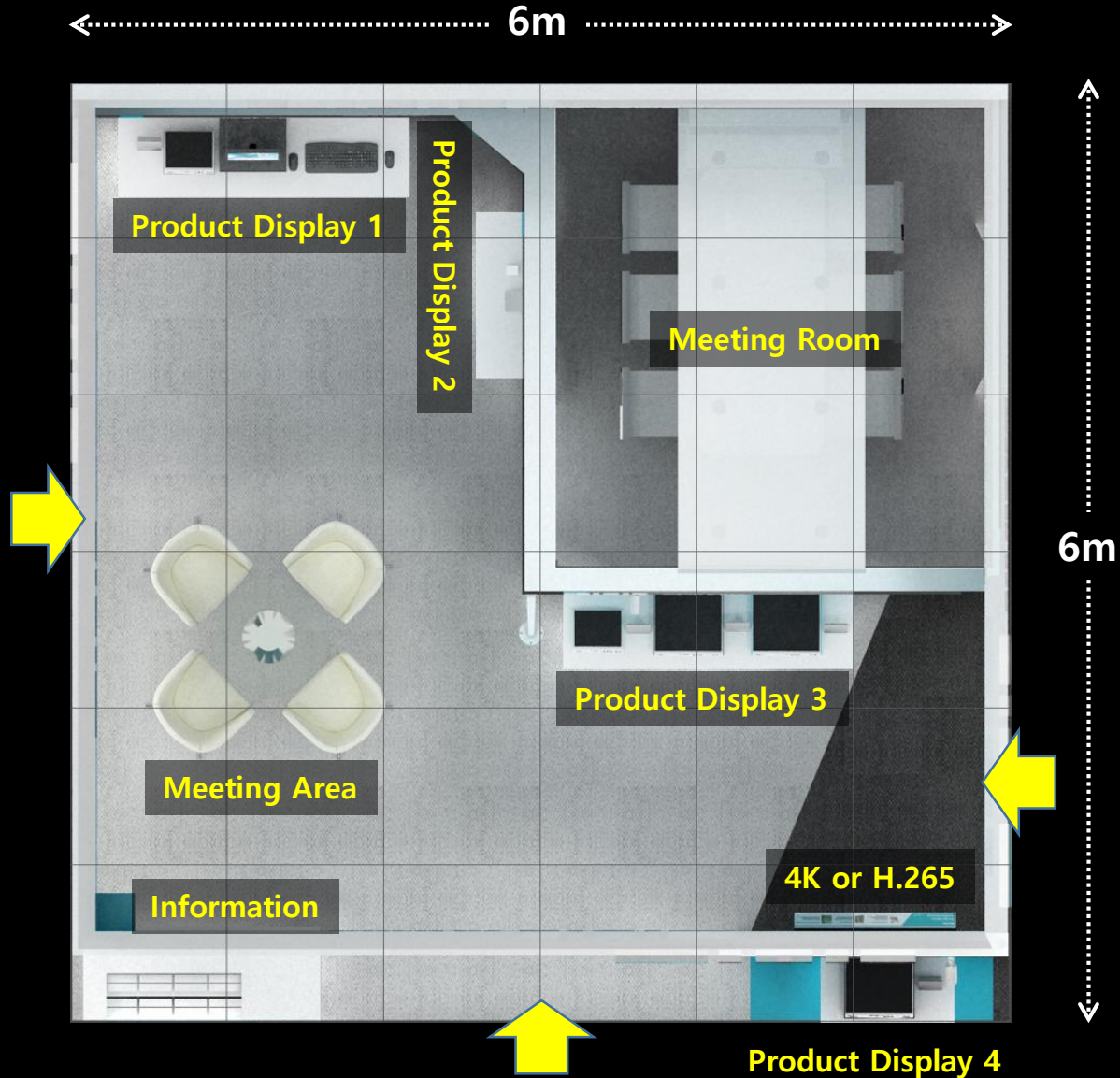

# Iso View: Type C



# Perspective: Type C



# Perspective: Type C



# Perspective: Type C



# Meeting Room (Type B & C)





**Thank you!**